

**SPECIFICATION:**

Current Rating : 1A Max.  
 Dielectric Withstanding Voltage : AC 750V For 1 Minute  
 Insulation Resistance : 1000 Megohms Minimum  
 Contact Resistance : 30 Milliohms Maximum  
 Total Mating Force : 3.0kgf Max.  
 Total Unmating Force : 0.5kgf  
 Operating Temperature : -55°C To +85°C  
 Contact : Copper Alloy, T=0.25mm  
           Selective Au Plated On Mating Area  
 Insulator : High Temperature Thermoplastic With G.F.  
           UL 94 V-0 Rated, Black  
 Shell : Spec, Up T=0.20mm, Down T=0.30mm

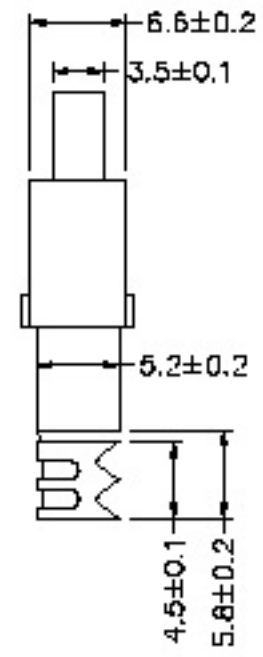
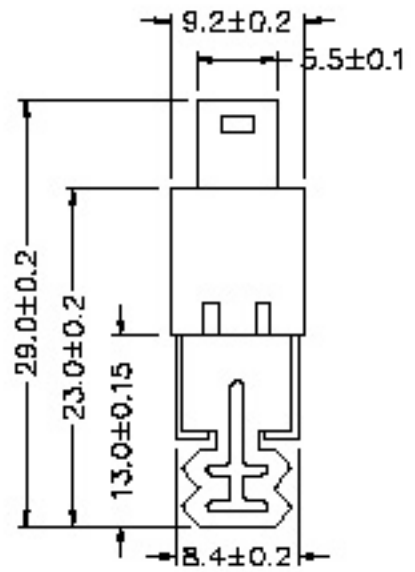

**MERITEC**

<http://www.meritec.co.kr>

CATEGROY		APPROVED BY		UNLESS OTHERWISE SPECIFIED TOLERANCES ARE						
PART No. FW1XD4PS		MCI		.X ±0.38						
DRAWING No. FW1XD4PS		LHC		.XX ±0.25						
SCALE NONE		HXY		ANG. ±1°						
REF.	A	UNIT	mm			ARFA	RFV	VISIONS	CHK	DATE